

PVC-C metric

Fittings

23 00 01

Bend 90°, PVC-C Radius = 2 d

- Radius = 2 d

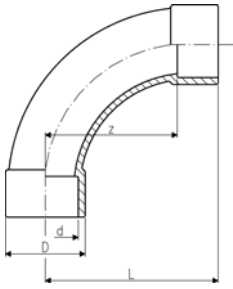

d [mm]	PN	Code	SP	kg	z [mm]	D [mm]	L [mm]
20	16	723 000 106	10	0.030	40	27	58
25	16	723 000 107	10	0.055	50	35	71
32	16	723 000 108	10	0.075	64	38	88
40	16	723 000 109	-	0.276	80	54	109
50	16	723 000 110	-	0.297	100	61	131
63	16	723 000 111	-	0.574	126	76	163
75	16	723 000 112	1	0.830	150	90	194
90	16	723 000 113	-	1.489	180	113	231
110	16	723 000 114	-	2.965	220	137	284
160	16	723 000 117	-	7.950	320	192	406

23 01 01

Bend 90°, short pattern, PVC-C Radius = 0,75 d

- Radius = 0,75 d



$r = 0,75 d$

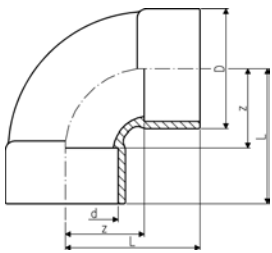

d [mm]	PN	Code	SP	kg	z [mm]	D [mm]	L [mm]
225	10	723 010 120	-	7.950	168	256	287

PVC-C metric

23 10 01

Elbow 90°, PVC-C

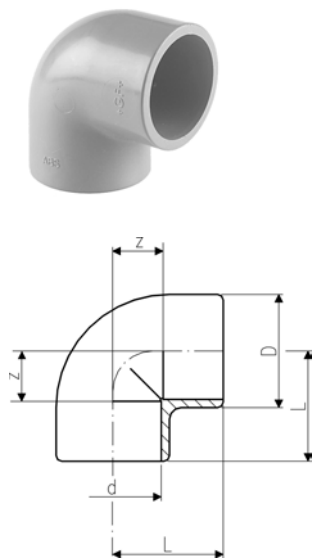

d [mm]	PN	Code	SP	kg	z [mm]	D [mm]	L [mm]
16	16	723 100 105	10	0.010	9	21	23
20	16	723 100 106	10	0.014	11	25	27
25	16	723 100 107	10	0.026	14	31	33
32	16	723 100 108	10	0.046	17	40	39
40	16	723 100 109	10	0.082	21	49	47
50	16	723 100 110	10	0.138	26	61	57
63	16	723 100 111	-	0.310	33	76	72
75	16	723 100 112	-	0.439	40	90	84
90	16	723 100 113	-	0.606	46	110	97
110	16	723 100 114	-	1.625	61	136	122
160	16	723 100 117	-	3.120	80	185	166

23 15 01

Elbow 45°, PVC-C



d [mm]	PN	Code	SP	kg	z [mm]	D [mm]	L [mm]
16	16	723 150 105	10	0.005	5	21	19
20	16	723 150 106	10	0.012	5	25	21
25	16	723 150 107	10	0.019	6	31	25
32	16	723 150 108	10	0.037	8	40	30
40	16	723 150 109	5	0.063	10	49	36
50	16	723 150 110	5	0.109	12	61	43
63	16	723 150 111	-	0.208	14	76	52
75	16	723 150 112	-	0.323	17	88	61
90	16	723 150 113	-	0.521	20	106	71
110	16	723 150 114	-	1.151	28	137	89
160	16	723 150 117	-	2.400	36	185	122
225	10	723 150 120	-	4.460	49	250	168

PVC-C metric

23 20 01

Tee 90°, PVC-C

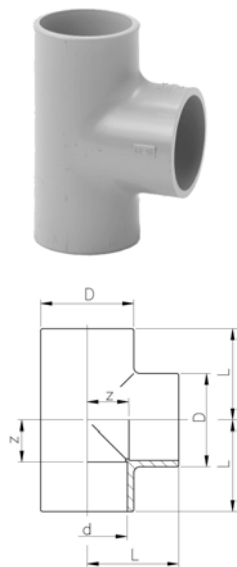

d [mm]	PN	Code	SP	kg	z [mm]	D [mm]	L [mm]	
16	16	723 200 105	10	0.014	9	21	23	
20	16	723 200 106	10	0.020	11	25	27	
25	16	723 200 107	10	0.034	14	31	33	
32	16	723 200 108	10	0.060	17	40	39	
40	16	723 200 109	10	0.106	21	49	47	
50	16	723 200 110	-	0.186	26	61	57	
63	16	723 200 111	-	0.360	34	76	72	
75	16	723 200 112	-	0.645	41	92	84	
90	16	723 200 113	-	1.118	46	111	97	
110	16	723 200 114	-	1.446	61	139	122	
160	16	723 200 117	-	5.280	81	193	167	
225	10	723 200 120	-	9.550	114	256	233	

23 25 01

Tee 45°, PVC-C



d [mm]	PN	Code	SP	kg	z [mm]	z1 [mm]	D [mm]	L [mm]	L1 [mm]	
20	10	723 250 106	10	0.039	30	6	28	68	46	
25	10	723 250 107	10	0.062	36	9	33	83	55	
32	10	723 250 108	10	0.108	45	10	41	99	67	
40	10	723 250 109	-	0.171	56	10	50	118	82	
50	10	723 250 110	-	0.287	66	12	60	140	97	
63	10	723 250 111	-	0.445	85	14	74	175	123	
75	6	723 250 112	-	0.870	101	18	91	207	145	
90	6	723 250 113	-	1.350	122	20	107	245	173	
110	6	723 250 114	-	2.695	149	27	134	298	210	

PVC-C metric

23 30 01

Crosses, PVC-C

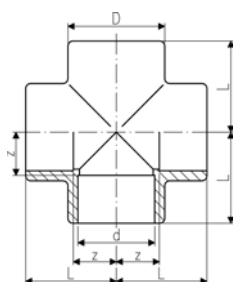

d [mm]	PN	Code	SP	kg	z [mm]	D [mm]	L [mm]	
32	16	723 300 108	-	0.101	17	43	39	
63	16	723 300 111	-	0.528	34	79	72	

23 20 01

Tees 90° reducing, PVC-C

*Tee 90° delivered with the required reducing bushes

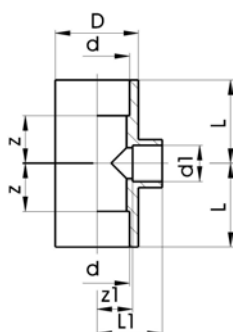

d [mm]	d1 [mm]	PN	Code	SP	kg	z [mm]	z1 [mm]	D [mm]	L [mm]	L1 [mm]	
25	20	16	723 200 134	10	0.042	14	14	33	33	30	
32	25	16	723 200 138	10	0.070	17	17	41	39	36	
40	25	16	723 200 151	10	0.120	23	23	50	49	42	
40	32	16	723 200 147	10	0.120	23	23	50	49	45	
50	20	16	723 200 009	5	0.196	28	28	62	59	44	
50	25	16	723 200 010	5	0.200	28	28	62	59	47	
50	32	16	723 200 164	5	0.200	28	28	62	59	50	
63	25	16	723 200 011	-	0.360	34	34	77	73	53	
63	32	16	723 200 178	-	0.368	35	34	77	73	56	
63	50	16	723 200 170	-	0.386	33	34	73	71	65	
*75	63	16	723 200 184	-	0.766	41		92	84		
*90	32	16	723 200 142	-	1.436	46		111	97		
*90	63	16	723 200 145	-	1.348	46		111	97		
*110	32	16	723 200 135	-	2.796	56		133	117		
*110	90	16	723 200 137	-	2.677	61		139	122		

PVC-C metric

23 91 01

Socket, PVC-C

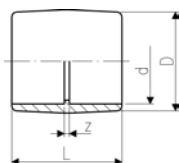

d [mm]	PN	Code	SP	kg	z [mm]	D [mm]	L [mm]
16	16	723 910 105	10	0.006	3	22	31
20	16	723 910 106	10	0.010	3	26	35
25	16	723 910 107	10	0.015	3	31	41
32	16	723 910 108	10	0.024	3	39	47
40	16	723 910 109	10	0.042	3	49	55
50	16	723 910 110	10	0.078	3	61	65
63	16	723 910 111	10	0.157	3	76	79
75	16	723 910 112	-	0.202	4	87	92
90	16	723 910 113	-	0.347	5	110	107
110	16	723 910 114	-	0.760	5	131	132
160	16	723 910 117	-	1.600	8	183	180
225	10	723 910 120	-	3.750	10	253	248

23 90 03

Reducing Bush (Short pattern), PVC-C

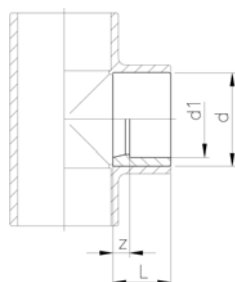

d [mm]	d1 [mm]	PN	Code	SP	kg	z [mm]	L [mm]
20	16	16	723 900 334	10	0.004	2	16
25	20	16	723 900 337	10	0.004	3	19
32	20	16	723 900 342	10	0.015	6	22
32	25	16	723 900 341	10	0.009	4	22
40	20	16	723 900 348	10	0.023	10	26
40	25	16	723 900 347	10	0.024	7	26
40	32	16	723 900 346	10	0.017	4	26
50	20	16	723 900 355	10	0.036	15	31
50	25	16	723 900 354	10	0.038	12	31
50	32	16	723 900 353	10	0.051	9	31
50	40	16	723 900 352	10	0.031	5	31
63	32	16	723 900 360	10	0.088	16	38
63	40	16	723 900 359	10	0.067	12	38
63	50	16	723 900 358	10	0.065	6	38
75	50	16	723 900 365	10	0.105	13	44
75	63	16	723 900 364	10	0.083	6	44
90	50	16	723 900 372	-	0.196	20	51
90	63	16	723 900 371	-	0.185	14	51
90	75	16	723 900 370	-	0.149	8	51
110	63	16	723 900 378	-	0.334	24	61
110	90	16	723 900 376	-	0.279	10	61
160	110	16	723 900 390	-	0.966	25	86
225	160	16	723 900 396	-	2.380	33	119

PVC-C metric

23 91 03

Reducing Bushes Long, PVC-C

Model:

- With spigot and solvent cement socket

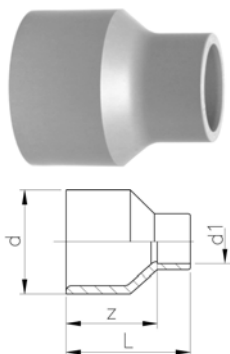

d [mm]	d1 [mm]	PN	Code	SP	kg	z [mm]	L [mm]
32	20	16	723 910 342	-	0.023	30	46
40	25	16	723 910 347	10	0.036	36	55
50	25	16	723 910 354	10	0.059	44	63
63	32	16	723 910 360	5	0.110	54	76
75	40	16	723 910 366	5	0.165	62	88
90	63	16	723 910 371	-	0.313	74	112

23 96 01

Cap, PVC-C



d [mm]	PN	Code	SP	kg	D [mm]	L [mm]
16	16	723 960 105	-	0.008	26	24
20	16	723 960 106	10	0.011	30	25
25	16	723 960 107	10	0.019	37	30
32	16	723 960 108	-	0.027	44	34
40	16	723 960 109	-	0.047	55	41
50	16	723 960 110	-	0.064	64	44
63	16	723 960 111	5	0.127	80	54
75	16	723 960 112	-	0.162	87	65
90	16	723 960 113	-	0.316	112	77
110	16	723 960 114	-	0.690	145	101
160	16	723 960 117	-	1.550	188	130

23 96 04

Hose Nozzle, PVC-C

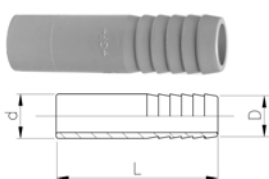

d [mm]	PN	Code	SP	kg	D [mm]	L [mm]
16	16	723 960 405	10	0.009	16	57
20	16	723 960 406	10	0.016	20	73
25	16	723 960 407	10	0.023	25	79
32	16	723 960 408	10	0.038	30	89

PVC-C metric

Adaptor Fittings

23 10 02

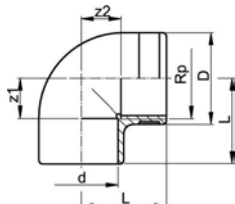

Elbows 90°, PVC-C

Model:

- With BSP parallel female thread (Rp) reinforced (A2)
- Reinforcing ring stainless (A2)
- Connection to plastic or metal
- Do not use thread sealing pastes that are harmful to PVC-C
- Install with low mechanical stress and avoid large cyclic temperature changes

d [mm]	Rp [inch]	PN	Code	SP	kg	z1 [mm]	z2 [mm]	D [mm]	L [mm]
20	1/2	16	723 100 206	-	0.024	11	14	30	27
25	3/4	16	723 100 207	10	0.037	14	17	35	33
32	1	16	723 100 208	-	0.064	17	22	45	39
40	1 1/4	16	723 100 209	-	0.134	23	27	55	50
50	1 1/2	16	723 100 210	-	0.200	27	36	62	58
63	2	16	723 100 211	-	0.376	33	46	75	73

23 91 02

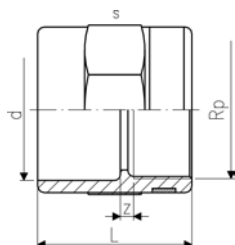

Socket, PVC-C

Model:

- With solvent cement socket metric and parallel female thread Rp
- Reinforcing ring stainless (A2)
- Connection to plastic or metal
- Do not use thread sealing pastes that are harmful to PVC-C
- Install with low mechanical stress and avoid large cyclic temperature changes

d [mm]	Rp [inch]	PN	Code	SP	kg	z [mm]	L [mm]	s [mm]
20	1/2	16	723 910 206	10	0.027	4	35	32
25	3/4	16	723 910 207	10	0.035	3	40	36
32	1	16	723 910 208	10	0.061	3	45	46
40	1 1/4	16	723 910 209	10	0.094	5	51	55
50	1 1/2	16	723 910 210	10	0.133	7	59	65
63	2	16	723 910 211	5	0.220	7	69	80

23 91 04

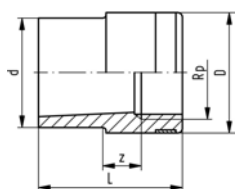

Reducing Bushes metric-Rp, PVC-C

Model:

- With solvent cement spigot metric and parallel female thread Rp
- Reinforcing ring stainless (A2)
- Connection to plastic or metal
- Install with low mechanical stress and avoid large cyclic temperature changes

d [mm]	Rp [inch]	PN	Code	SP	kg	Z [mm]	D [mm]	L [mm]	s [mm]
20	3/8	16	723 910 434	10	0.016	24	25	35	15
25	1/2	16	723 910 437	10	0.023	27	30	41	21
32	3/4	16	723 910 441	10	0.035	32	35	48	33
40	1	16	723 910 446	10	0.064	38	45	56	60
50	1 1/4	16	723 910 452	10	0.105	46	55	66	99
63	1 1/2	16	723 910 458	5	0.153	57	62	77	150

PVC-C metric

23 91 05

Adaptor Nipples, PVC-C

Model:

- With solvent cement spigot metric and taper male thread R
- Connection to plastic thread only
- Do not use thread sealing pastes that are harmful to PVC-C
- Install with low mechanical stress and avoid large cyclic temperature changes

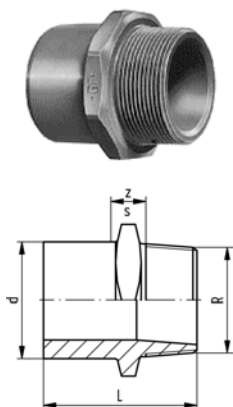

d [mm]	R [inch]	PN	Code	SP	kg	z [mm]	s [mm]
16	3/8	16	723 910 505	-	0.012	35	27

23 91 05

Adaptor Socket-Nipple, PVC-C

Model:

- With solvent cement spigot/socket metric and taper male thread R
- Connection to plastic thread only
- Do not use thread sealing pastes that are harmful to PVC-C
- Install with low mechanical stress and avoid large cyclic temperature changes

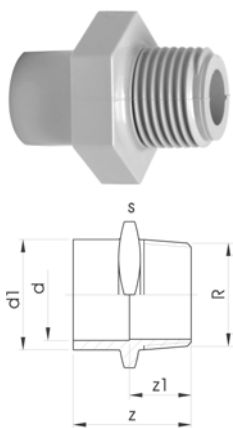

d [mm]	R [inch]	d1 [mm]	PN	Code	SP	kg	z [mm]	z1 [mm]	s [mm]
16	1/2	20	16	723 910 556	10	0.018	42	28	32
20	3/4	25	16	723 910 557	10	0.026	47	31	36
25	1	32	16	723 910 558	10	0.044	54	35	46
32	1 1/4	40	16	723 910 559	10	0.072	60	38	55
40	1 1/2	50	16	723 910 560	10	0.101	66	40	65
50	2	63	16	723 910 561	5	0.173	78	47	80

PVC-C metric

Unions

23 51 01

Solvent Cement Unions, PVC-C

Model:

- Union end: Solvent cement socket metric
- Union bush: Solvent cement socket metric
- Gasket: O-Ring EPDM No. 48 41 00, FPM No. 49 41 00

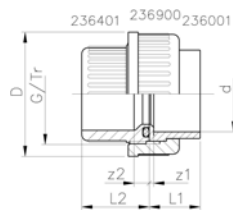

d [mm]	PN	EPDM Code	FPM Code	SP	kg	z1 [mm]	z2 [mm]	D [mm]	L1 [mm]	L2 [mm]	G/Tr
16	16	723 510 105	723 510 130	-	0.027	3	8	35	19	24	3/4
20	16	723 510 106	723 510 131	-	0.044	3	9	43	21	26	1
25	16	723 510 107	723 510 132	-	0.072	3	9	53	24	29	1 1/4
32	16	723 510 108	723 510 133	-	0.098	3	9	60	27	32	1 1/2
40	16	723 510 109	723 510 134	-	0.167	3	10	74	32	38	2
50	16	723 510 110	723 510 135	-	0.098	3	10	83	33	40	2 1/4
63	16	723 510 111	723 510 136	-	0.400	3	10	103	40	46	2 3/4
75	10	723 510 112	723 510 137	-	0.670	3	18	135	47	62	Tr108x5
90	10	723 510 113	723 510 138	-	1.008	5	18	158	56	69	Tr128x5
110	10	723 510 114	723 510 139	-	1.553	5	11	188	66	72	Tr154x6

PVC-C metric

23 51 02

Adaptor Unions, PVC-C metric-Rp

Model:

- Union end: Solvent cement socket metric
- Union Bush: Parallel female thread Rp
- Gasket: O-Ring EPDM No. 48 41 00, FPM No. 49 41 00
- Connection to plastic thread only
- Do not use thread sealing pastes that are harmful to PVC-C

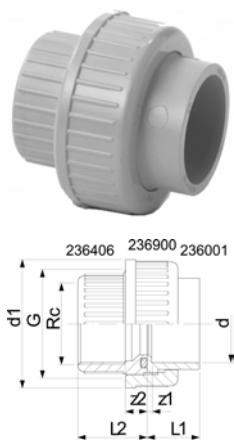

d [mm]	Rp [inch]	PN	EPDM Code	FPM Code	SP	kg	z1 [mm]	z2 [mm]	D [mm]	L1 [mm]	L2 [mm]	G [inch]
16	3/8	16	723 510 205	723 510 230	-	0.022	3	13	35	17	24	3/4
20	1/2	16	723 510 206	723 510 231	-	0.040	3	13	43	19	26	1
25	3/4	16	723 510 207	723 510 232	-	0.065	3	14	51	22	29	1 1/4
32	1	16	723 510 208	723 510 233	-	0.103	3	15	58	25	32	1 1/2
40	1 1/4	16	723 510 209	723 510 234	-	0.174	3	19	74	29	38	2
50	1 1/2	16	723 510 210	723 510 235	-	0.239	3	26	83	34	45	2 1/4
63	2	16	723 510 211	723 510 236	-	0.435	3	33	100	41	56	2 3/4

23 51 41

Adaptor Unions, PVC-C metric-ASTM

Model:

- Union end: solvent cement socket inch ASTM
- Union bush: Solvent cement socket metric
- Gasket: O-Ring EPDM No. 48 41 00, FPM No. 49 41 00

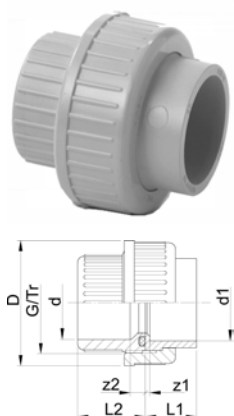

d [mm]	Inch	PN	EPDM Code	FPM Code	SP	kg	z1 [mm]	z2 [mm]	D [mm]	L1 [mm]	L2 [mm]	G [inch]
16	3/8	10	723 514 105	723 514 130	-	0.022	4	10	35	17	24	3/4
20	1/2	10	723 514 106	723 514 131	-	0.047	2	10	43	19	26	1
25	3/4	10	723 514 107	723 514 132	-	0.065	4	10	51	22	29	1 1/4
32	1	10	723 514 108	723 514 133	-	0.103	4	10	58	25	32	1 1/2
40	1 1/4	10	723 514 109	723 514 134	-	0.174	6	12	74	29	38	2
50	1 1/2	10	723 514 110	723 514 135	-	0.239	11	14	83	34	40	2 1/4
63	2	10	723 514 111	723 514 136	-	0.435	17	18	100	41	46	2 3/4

PVC-C metric

23 54 02

Adaptor Unions, Stainless Steel / PVC-C metric - Rp

Model:

- Union End: stainless steel WN 1.4404 (316L), parallel female thread Rp
- Union Bush: Solvent cement socket PVC-C metric
- Union nut: PVC-C
- Gasket: O-Ring EPDM No. 48 41 00, FPM No. 49 41 00

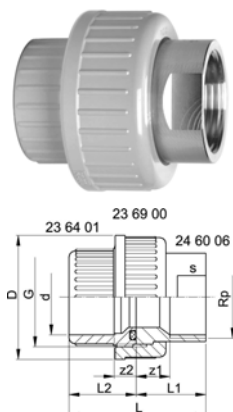

d [mm]	Rp [inch]	PN	EPDM Code	FPM Code	SP	kg
16	3/8	16	723 540 205	723 540 230	-	0.053
20	1/2	16	723 540 206	723 540 231	-	0.096
25	3/4	16	723 540 207	723 540 232	-	0.154
32	1	16	723 540 208	723 540 233	-	0.212
40	1 1/4	16	723 540 209	723 540 234	-	0.356
50	1 1/2	16	723 540 210	723 540 235	-	0.455
63	2	16	723 540 211	723 540 236	-	0.721

d [mm]	z1 [mm]	z2 [mm]	D [mm]	L [mm]	L1 [mm]	L2 [mm]	G [inch]	s [mm]
16	9	10	35	43	19	24	3/4	19
20	11	10	43	50	24	26	1	24
25	11	10	51	55	26	29	1 1/4	29
32	12	10	58	61	29	32	1 1/2	36
40	14	12	74	71	33	38	2	45
50	15	14	83	79	34	45	2 1/4	54
63	15	18	100	95	39	56	2 3/4	63

23 54 07

Adaptor Unions, Stainless Steel / PVC-C metric - R

Model:

- Union End: stainless steel WN 1.4404 (316L), taper male thread R
- Union Bush: Solvent cement socket PVC-C metric
- Union nut: PVC-C
- Gasket: O-Ring EPDM No. 48 41 00, FPM No. 49 41 00

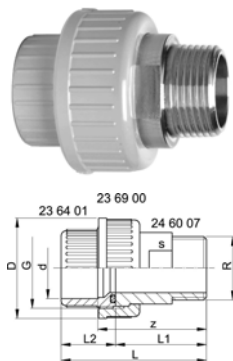

d [mm]	R [inch]	PN	EPDM Code	FPM Code	SP	kg
16	3/8	16	723 540 705	723 540 730	-	0.073
20	1/2	16	723 540 706	723 540 731	-	0.126
25	3/4	16	723 540 707	723 540 732	-	0.174
32	1	16	723 540 708	723 540 733	-	0.262
40	1 1/4	16	723 540 709	723 540 734	-	0.476
50	1 1/2	16	723 540 710	723 540 735	-	0.535
63	2	16	723 540 711	723 540 736	-	0.931

d [mm]	z [mm]	D [mm]	L [mm]	L1 [mm]	L2 [mm]	G [inch]	s [mm]
16	40	35	54	30	24	3/4	19
20	44	43	60	34	26	1	24
25	46	51	65	36	29	1 1/4	32
32	50	58	72	40	32	1 1/2	37
40	58	74	84	46	38	2	48
50	62	83	93	48	45	2 1/4	54
63	73	100	111	55	56	2 3/4	69

PVC-C metric

23 54 55

Adaptor Unions, Stainless Steel / PVC-C metric - Welding End

Model:

- Union End: Stainless steel 1.4404 (316L) with welding end
- Union Bush: Solvent cement socket PVC-C metric
- Union Nut: stainless steel WN 1.4404 (316L)
- Gasket: O-Ring EPDM No. 48 41 00, FPM No. 49 41 00

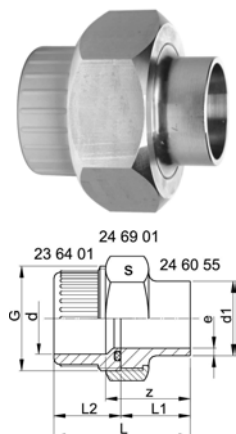

d [mm]	d1 [mm]	PN	EPDM Code	FPM Code	SP	kg
16	17	16	723 545 505	723 545 530	-	0.101
20	21	16	723 545 506	723 545 531	-	0.176
25	27	16	723 545 507	723 545 532	-	0.204
32	34	16	723 545 508	723 545 533	-	0.313
40	42	16	723 545 509	723 545 534	-	0.493
50	48	16	723 545 510	723 545 535	-	0.566
63	60	16	723 545 511	723 545 536	-	0.902

d [mm]	z [mm]	L [mm]	L1 [mm]	L2 [mm]	e [mm]	G [inch]	s [mm]
16	28	42	18	24	1.6	3/4	32
20	32	48	22	26	2.0	1	41
25	33	52	23	29	2.0	1 1/4	46
32	36	58	26	32	2.0	1 1/2	55
40	38	64	26	38	2.0	2	68
50	42	73	28	45	2.0	2 1/4	74
63	50	88	32	56	2.6	2 3/4	88

23 53 02

Adaptor Union Malleable Iron/ PVC-C Rp-metric

Model:

- Union End: PVC-C, solvent cement
- Union Bush: Malleable iron galvanized parallel female thread (Rp)
- Union Nut: malleable iron galvanized
- Gasket: Flat gasket No. 48 40 00 EPDM

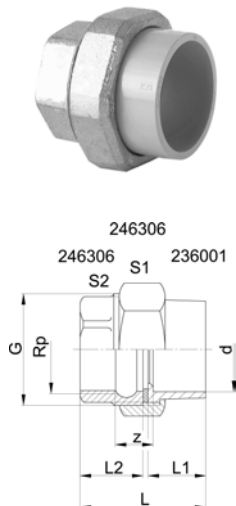

d [mm]	Rp [inch]	PN	Code	kg	z [mm]	G [inch]	L1 [mm]	L2 [mm]	S1 [mm]	S2 [mm]
20	1/2	16	723 530 206	0.128	49	1	21	25	39	25
25	3/4	16	723 530 207	0.206	55	1 1/4	24	28	48	31
32	1	16	723 530 208	0.269	59	1 1/2	27	31	55	38
40	1 1/4	16	723 530 209	0.443	64	2	32	33	67	47
50	1 1/2	16	723 530 210	0.549	68	2 1/4	33	36	74	53
63	2	16	723 530 211	0.888	77	2 3/4	40	42	90	66

PVC-C metric

23 53 07

Adaptor Unions Malleable Iron / PVC-C R-metric

Model:

- Union End: PVC-C, solvent cement
- Union Bush: Malleable iron galvanized, taper male thread (R)
- Union Nut: malleable iron galvanized
- Gasket: Flat gasket No. 48 40 00 EPDM

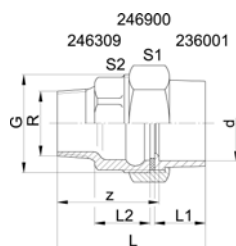

d	R	PN	Code	kg	z	G	L1	L2	S1	S2
[mm]	[inch]				[mm]	[inch]	[mm]	[mm]	[mm]	[mm]
20	1/2	16	723 530 706	0.159	12	1	21	20	39	25
25	3/4	16	723 530 707	0.254	13	1 1/4	24	23	48	31
32	1	16	723 530 708	0.355	14	1 1/2	27	26	55	38
40	1 1/4	16	723 530 709	0.592	15	2	32	28	67	47
50	1 1/2	16	723 530 710	0.701	15	2 1/4	33	29	74	53
63	2	16	723 530 711	0.998	16	2 3/4	40	34	90	66

23 55 02

Adapter Union Brass / PVC-C Rp-metric

Model:

- Union End: PVC-C, solvent cement
- Union Bush: Brass BSP parallel female thread (Rp)
- Union Nut: brass
- Gasket: Flat gasket No. 48 40 00 EPDM

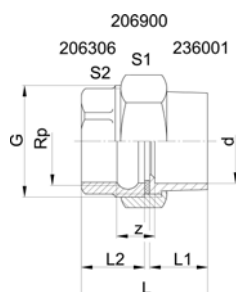

d	Rp	PN	Code	kg	z	G	L1	L2	S1	S2
[mm]	[inch]				[mm]	[inch]	[mm]	[mm]	[mm]	[mm]
16	3/8	16	723 550 205	0.093	34	3/4	19	17	30	27
20	1/2	16	723 550 206	0.190	38	1	21	20	38	27
25	3/4	16	723 550 207	0.236	55	1 1/4	24	23	47	32
32	1	16	723 550 208	0.293	59	1 1/2	27	26	52	38
40	1 1/4	16	723 550 209	0.507	60	2	32	28	66	47
50	1 1/2	16	723 550 210	0.540	67	2 1/4	33	29	72	53
63	2	16	723 550 211	0.904	75	2 3/4	40	34	87	65

PVC-C metric

23 55 07

Adaptor Unions Brass / PVC-C R-metric



Model:

- Union End: PVC-C, solvent cement
- Union Bush: Brass, BSP, taper male thread R
- Union Nut: brass
- Gasket: Flat gasket No. 48 40 00 EPDM

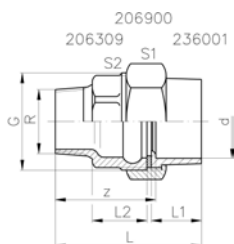

d [mm]	R [inch]	PN	Code	kg	z [mm]	G [inch]	L1 [mm]	L2 [mm]	S1 [mm]	S2 [mm]
16	3/8	16	723 550 705	0.117	3	3/4	19	29	30	27
20	1/2	16	723 550 706	0.149	3	1	21	32	38	27
25	3/4	16	723 550 707	0.290	3	1 1/4	24	50	47	27
32	1	16	723 550 708	0.361	3	1 1/2	27	54	52	34
40	1 1/4	16	723 550 709	0.644	3	2	32	54	66	43
50	1 1/2	16	723 550 710	0.743	3	2 1/4	33	62	72	50
63	2	16	723 550 711	1.190	3	2 3/4	40	69	87	61

PVC-C metric

23 60 01

Union End, PVC-C

Model:

- For union 23 51 01

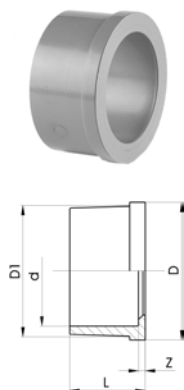

d [mm]	PN	Code	SP	kg	z [mm]	D [mm]	D1 [mm]	L [mm]
16	16	723 600 105	-	0.005	3	24	22.00	19
20	16	723 600 106	-	0.010	4	30	28.00	21
25	16	723 600 107	-	0.018	3	39	36.00	24
32	16	723 600 108	-	0.023	3	44	41.00	27
40	16	723 600 109	-	0.062	3	57	53.00	31
50	16	723 600 110	-	0.064	3	63	59.00	34
63	16	723 600 111	-	0.120	3	78	74.00	41
75	10	723 600 162	-	0.157	3	101	91.00	47
90	10	723 600 163	-	0.260	5	121	108.00	56
110	10	723 600 164	-	0.418	5	146	131.00	66

23 60 20

Union Ends, PVC-C ASTM

Model:

- Solvent cement socket ASTM

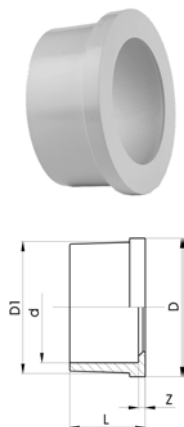

Inch	PN	Code	SP	kg	z [mm]	D [mm]	D1 [mm]	L [mm]
3/8	16	723 602 005	-	0.007	3	24	22.00	22
1/2	16	723 602 006	-	0.010	3	30	27.50	25
3/4	16	723 602 007	-	0.017	3	39	36.00	28
1	16	723 602 008	-	0.024	3	45	41.50	32
1 1/4	16	723 602 009	-	0.040	3	57	53.00	35
1 1/2	16	723 602 010	-	0.057	3	63	59.00	38
2	16	723 602 011	-	0.096	3	78	74.00	41

PVC-C metric

23 64 01

Union Bush, PVC-C

Model:

- Solvent cement socket metric
- For union 23 51 01
- Jointing face: with O-Ring groove
- Gasket: O-Ring EPDM No. 48 41 00, FPM No. 49 41 00

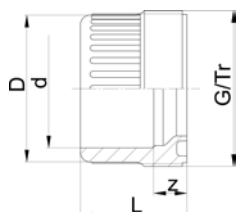

d [mm]	PN	Code	SP	kg	z [mm]	D [mm]	L [mm]	G/Tr
16	16	723 640 105	-	0.009	11	24	25	3/4
20	16	723 640 106	-	0.014	12	28	26	1
25	16	723 640 107	-	0.024	11	33	29	1 1/4
32	16	723 640 108	-	0.034	10	41	32	1 1/2
40	16	723 640 109	-	0.058	12	50	38	2
50	16	723 640 110	-	0.079	14	62	45	2 1/4
63	16	723 640 111	-	0.147	19	77	56	2 3/4
75	10	723 640 112	-	0.230	18	93	62	Tr108x5
90	10	723 640 113	-	0.345	18	110	69	Tr128x5
110	10	723 640 114	-	0.480	11	133	72	Tr154x6

23 64 06

Union Bushes Rp, PVC-C

Model:

- With parallel female thread Rp
- Jointing Face: with O-Ring groove
- Gasket: O-Ring EPDM No. 48 41 00, FPM No. 49 41 00
- Connection to plastic thread only
- Do not use thread sealing pastes that are harmful to PVC-C

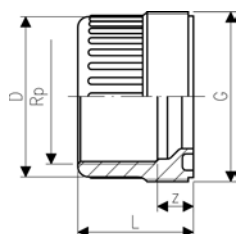

Rp [inch]	PN	Code	SP	kg	z [mm]	D [mm]	L [mm]	G [inch]
3/8	10	723 640 605	-	0.012	13	24	24	3/4
1/2	10	723 640 606	-	0.015	13	29	26	1
3/4	10	723 640 607	-	0.024	14	34	29	1 1/4
1	10	723 640 608	10	0.034	15	42	32	1 1/2
1 1/4	10	723 640 609	10	0.060	19	53	38	2
1 1/2	10	723 640 610	-	0.092	26	63	45	2 1/4
2	10	723 640 611	-	0.114	33	78	56	2 3/4

PVC-C metric

23 69 00

Union Nut, PVC-C

Model:

- For union 23 51 01

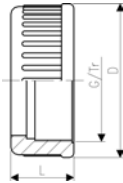

d [mm]	PN	Code	SP	kg	D [mm]	L [mm]	G/Tr
16	16	723 690 005	-	0.012	35	21	3/4
20	16	723 690 006	-	0.020	43	23	1
25	16	723 690 007	-	0.022	51	24	1 1/4
32	16	723 690 008	-	0.032	58	26	1 1/2
40	16	723 690 009	-	0.053	72	29	2
50	16	723 690 010	-	0.100	83	34	2 1/4
63	16	723 690 011	-	0.141	100	38	2 3/4
75	10	723 690 012	-	0.271	135	40	Tr108x5
90	10	723 690 013	-	0.383	158	43	Tr128x5
110	10	723 690 014	-	0.609	188	48	Tr154x6

PVC-C metric

Flange Adaptors

23 79 01

Flange Adaptor (Serrated face), PVC-C

Model:

- Jointing faces serrated
- Counterpart: Flange Adaptor No. 23 79 01
- Gasket: Flat gasket No. 48 40 01 EPDM or No.49 40 01 FPM
- Flange: No. 27 70 04, 27 70 02, 23 70 00
- d160 and d225 can be used as serrated or flat flange adaptor

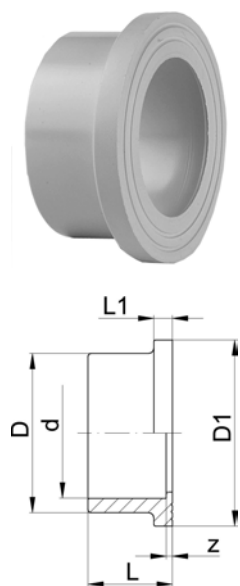

d [mm]	PN	Code	SP	kg	z [mm]	D [mm]	D1 [mm]	L [mm]	L1 [mm]
20	16	723 790 106	10	0.012	3	27	34.00	21	6
25	16	723 790 107	-	0.018	3	33	41.00	24	7
32	16	723 790 108	10	0.026	3	41	50.00	27	7
40	16	723 790 109	-	0.044	3	50	61.00	30	8
50	16	723 790 110	-	0.060	3	61	73.00	34	8
63	16	723 790 111	-	0.106	3	76	90.00	41	9
75	16	723 790 112	-	0.167	3	91	106.00	47	10
90	16	723 790 113	-	0.271	5	108	125.00	56	11
110	16	723 790 114	-	0.432	5	131	150.00	66	12
160	16	723 790 117	-	1.200	5	188	213.00	91	16
200	10	723 790 119	-	1.630	6	224	250.00	112	24
225	10	723 790 120	-	1.900	6	248	274.00	125	25

23 81 01

Flange Adaptor, with O-ring groove, PVC-C

Model:

- Jointing Face: with O-Ring groove
- Counterpart: Flange Adaptor No. 23 79 01
- Gasket: O-ring EPDM No. 48 41 01, FPM No. 49 41 01
- Flange: No. 27 70 04, 27 70 02, 23 70 00

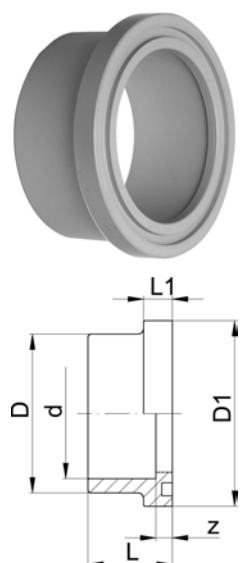

d [mm]	PN	Code	SP	kg	z [mm]	D [mm]	D1 [mm]	L [mm]	L1 [mm]
160	16	723 810 117	-	1.300	11	188	213.00	97	22
225	10	723 810 120	-	2.050	12	248	274.00	131	31

PVC-C metric

Flanges

23 70 00

PVC-C Backing Flange for Socket Systems metric

Model:

- Connecting dimension: ISO 2501 PN 10
- Maximum temperature +60°C
- Material: PVC-C

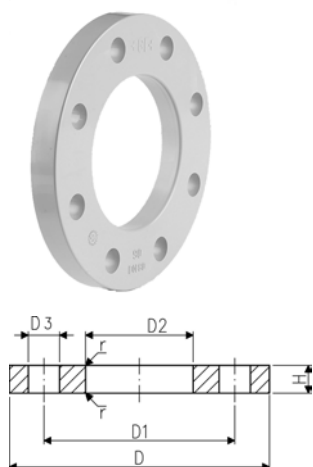

d [mm]	DN [mm]	PN	Code	SP	kg
63	50	10	723 700 011	-	0.330
75	63	10	723 700 012	-	0.402
90	80	10	723 700 013	-	0.510
110	100	10	723 700 014	-	0.600

d [mm]	D [mm]	D1 [mm]	D2 [mm]	D3 [mm]	H [mm]	r [mm]	AL	SC
63	165	125.00	78.00	18.0	18	3	4	M 16
75	185	145.00	92.00	18.0	19	3	4	M 16
90	200	160.00	110.00	18.0	20	3	8	M 16
110	220	180.00	133.00	18.0	22	3	8	M 16

27 70 04
27 70 05

Backing Flanges, PP-V for Socket Systems metric

Model:

- Modern full-plastic flange PP-GF (30 % glass-fibre reinforced)
- With V-groove which applies force evenly on collar
- With integrated bolt retainers as an assembly aid
- Connecting dimension: ISO 7005 PN 10, EN 1092 PN 10, DIN 2501 PN 10

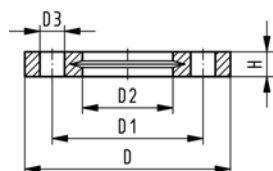

1) Suitable for socket- and butt fusion systems (no pictograph on flange)

d [mm]	DN [mm]	PN	Code	D [mm]	D1 [mm]	D2 [mm]	D3 [mm]	H [mm]	AL	SC
120	15	16	727 700 406	95	65.00	28.00	14.0	16	4	M12
125	20	16	727 700 407	105	75.00	34.00	14.0	17	4	M12
132	25	16	727 700 408	115	85.00	42.00	14.0	18	4	M12
140	32	16	727 700 409	140	100.00	51.00	18.0	20	4	M16
150	40	16	727 700 410	150	110.00	62.00	18.0	22	4	M16
163	50	16	727 700 411	165	125.00	78.00	18.0	24	4	M16
175	65	16	727 700 412	185	145.00	92.00	18.0	26	4	M16
190	80	16	727 700 413	200	160.00	110.00	18.0	27	8	M16
110	100	16	727 700 414	220	180.00	133.00	18.0	28	8	M16
140	125	16	727 700 416	250	210.00	167.00	18.0	30	8	M16
160	150	16	727 700 417	285	241.00	190.00	22.0	32	8	M20
200	200	16	727 700 419	340	296.50	226.00	22.0	34	8	M20
225	200	16	727 700 420	340	295.00	250.00	22.0	34	8	M20
250	250	16	727 700 421	395	350.00	277.00	22.0	38	12	M20
280	250	16	727 700 422	395	350.00	310.00	22.0	38	12	M20
315	300	16	727 700 423	445	400.00	348.00	22.0	42	12	M20

PVC-C metric

27 70 04
27 70 05

Backing Flanges, PP-V for Butt Fusion Systems metric

Model:

- Modern full-plastic flange PP-GF (30 % glass-fibre reinforced)
- With V-groove which applies force evenly on collar
- With integrated bolt retainers as an assembly aid
- Connecting dimension: ISO 7005 PN 10, EN 1092 PN 10, DIN 2501 PN 10

¹⁾ Suitable for socket- and butt fusion systems (no pictograph on flange)

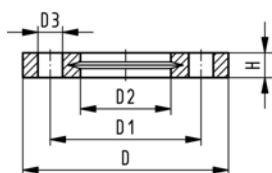

d [mm]	DN [mm]	PN	Code	D [mm]	D1 [mm]	D2 [mm]	D3 [mm]	H [mm]	AL	SC
20	15	16	727 700 406	95	65.00	28.00	14.0	16	4	M12
25	20	16	727 700 407	105	75.00	34.00	14.0	17	4	M12
32	25	16	727 700 408	115	85.00	42.00	14.0	18	4	M12
40	32	16	727 700 409	140	100.00	51.00	18.0	20	4	M16
50	40	16	727 700 410	150	110.00	62.00	18.0	22	4	M16
63	50	16	727 700 411	165	125.00	78.00	18.0	24	4	M16
75	65	16	727 700 412	185	145.00	92.00	18.0	26	4	M16
90	80	16	727 700 513	200	160.00	108.00	18.0	27	8	M16
110	100	16	727 700 514	220	180.00	128.00	18.0	28	8	M16
125	100	16	727 700 515	220	180.00	135.00	18.0	28	8	M16
140	125	16	727 700 516	250	210.00	158.00	18.0	30	8	M16
160	150	16	727 700 517	285	241.00	178.00	22.0	32	8	M20
180	150	16	727 700 518	285	240.00	188.00	22.0	32	8	M20
200	200	16	727 700 519	340	295.00	235.00	22.0	34	8	M20
225	200	16	727 700 520	340	295.00	238.00	22.0	34	8	M20
250	250	16	727 700 521	395	350.00	288.00	22.0	38	12	M20
280	250	16	727 700 522	395	350.00	294.00	22.0	38	12	M20
315	300	16	727 700 523	445	400.00	338.00	22.0	42	12	M20

27 70 02
27 70 03

Backing Flanges, PP/Steel for Socket Systems metric

Model:

- Material: PP (30 % glass-fibre reinforced) with steel ring
- Connecting dimensions: ISO 7005 / EN 1092 / DIN 2501 PN10

¹⁾ Attention: bolt circle according ISO 2536

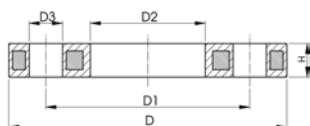

d [mm]	DN [mm]	PN	Code	SP	kg	D [mm]	D1 [mm]	D2 [mm]	D3 [mm]	H [mm]	AL	SC
20	15	16	727 700 206	-	0.220	95	65	28	14	12	4	M12
25	20	16	727 700 207	-	0.260	105	75	34	14	12	4	M12
32	25	16	727 700 208	-	0.430	115	85	42	14	16	4	M12
40	32	16	727 700 209	-	0.650	140	100	51	18	16	4	M16
50	40	16	727 700 210	-	0.820	150	110	62	18	18	4	M16
63	50	16	727 700 211	-	0.940	165	125	78	18	18	4	M16
75	65	16	727 700 212	-	1.300	185	145	92	18	18	4	M16
90	80	16	727 700 213	-	1.400	200	160	110	18	20	8	M16
110	100	16	727 700 214	-	1.560	220	180	133	18	20	8	M16
125	125	16	727 700 215	-	2.590	250	210	150	18	24	8	M16
140	125	16	727 700 216	-	2.120	250	210	167	18	24	8	M16
160	150	16	727 700 217	-	3.390	285	240	190	22	24	8	M20
200	200	16	727 700 219	-	5.850	340	295	226	22	27	8	M20
225	200	16	727 700 220	-	4.410	340	295	250	22	27	8	M20
250	250	16	727 700 021	-	8.340	395	350.00	277.00	22.0	30	12	M20
*250	250	16	727 700 221	-	8.340	395	325	277	22	30	8	M20
280	250	16	727 700 222	-	5.520	395	350	310	22	30	12	M20
315	300	16	727 700 223	-	7.600	445	400	348	22	34	12	M20
355	350	16	727 700 224	-	13.960	515	460	388	23	40	16	M20
400	400	16	727 700 225	-	17.380	574	515	442	26	40	16	M24

PVC-C metric

27 70 02
27 70 03

Backing Flanges, PP/Steel for Butt Fusion Systems metric

Model:

- Material: PP (30 % glass-fibre reinforced) with steel ring
- Connecting dimensions: ISO 7005 / EN 1092 / DIN 2501 PN10

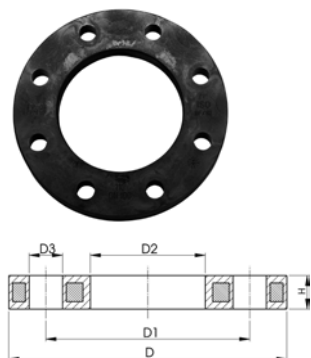

d	DN	PN	Code	D	D1	D2	D3	H	AL	SC
[mm]	[mm]			[mm]	[mm]	[mm]	[mm]	[mm]		
20	15	16	727 700 206	95	65	28	14	12	4	M12
25	20	16	727 700 207	105	75	34	14	12	4	M12
32	25	16	727 700 208	115	85	42	14	16	4	M12
40	32	16	727 700 209	140	100	51	18	16	4	M16
50	40	16	727 700 210	150	110	62	18	18	4	M16
63	50	16	727 700 211	165	125	78	18	18	4	M16
75	65	16	727 700 212	185	145	92	18	18	4	M16
90	80	16	727 700 313	200	160.00	108.00	18.0	20	8	M16
110	100	16	727 700 314	220	180.00	128.00	18.0	20	8	M16
125	100	16	727 700 315	220	180.00	135.00	18.0	20	8	M16
140	125	16	727 700 316	250	210.00	158.00	18.0	24	8	M16
160	150	16	727 700 317	285	240.00	178.00	22.0	24	8	M20
180	150	16	727 700 318	285	240.00	188.00	22.0	24	8	M20
200	200	16	727 700 319	340	295.00	235.00	22.0	27	8	M20
225	200	16	727 700 320	340	295.00	238.00	22.0	27	8	M20
250	250	16	727 700 321	395	350.00	288.00	22.0	30	12	M20
280	250	16	727 700 322	395	350.00	294.00	22.0	30	12	M20
315	300	16	727 700 323	445	400.00	338.00	22.0	34	12	M20
355	350	16	727 700 324	515	460.00	376.00	23.0	40	16	M20
400	400	16	727 700 325	574	515.00	430.00	26.0	40	16	M24

27 70 14
27 70 15

Backing Flanges, PP-V for Socket Systems Inch/ANSI

Model:

- Modern full-plastic flange PP-GF (30 % glass-fibre reinforced)
- With V-groove which applies force evenly on collar
- With integrated bolt-fixing as an assembly aid
- Connection dimensions according to ANSI B 16.5, ASTM D 4024; bolt circle class 150



1) Suitable for socket- and butt fusion systems (no pictograph on flange)

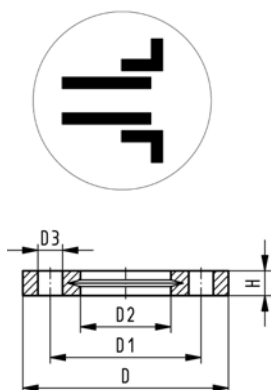

d	DN	Inch	PN	Code	kg	D	D1	D2	D3	H	AL	SC
[mm]	[mm]					[mm]	[mm]	[mm]	[mm]	[mm]		
	15	1/2	16	727 701 406	0.080	95	60.00	28.00	16.0	16	4	M12
	20	3/4	16	727 701 407	0.100	105	70.00	34.00	16.0	17	4	M12
	25	1	16	727 701 408	0.140	115	79.00	42.00	16.0	18	4	M12
	32	1 1/4	16	727 701 409	0.220	140	89.00	51.00	16.0	20	4	M16
	40	1 1/2	16	727 701 410	0.210	150	98.00	62.00	16.0	22	4	M16
	50	2	16	727 701 411	0.380	165	121.00	78.00	19.0	24	4	M16
	65	2 1/2	16	727 701 412	0.480	185	140.00	92.00	19.0	26	4	M16
	80	3	16	727 701 413	0.520	200	152.00	110.00	19.0	27	4	M16
	110	4	16	727 701 414	0.680	229	190.00	133.00	19.0	28	8	M16
	160		16	727 700 417	1.200	285	241.00	190.00	22.0	32	8	M20
	225		16	727 700 420	1.400	340	295.00	250.00	22.0	34	8	M20
	250	10	16	727 701 422	1.700	406	362.00	310.00	26.0	38	12	M20
	300	12	16	727 701 423	2.400	483	432.00	348.00	26.0	42	12	M20